



N10-006^{Q&As}

CompTIA Network+ certification

Pass CompTIA N10-006 Exam with 100% Guarantee

Free Download Real Questions & Answers **PDF** and **VCE** file from:

<https://www.passapply.com/N10-006.html>

100% Passing Guarantee
100% Money Back Assurance

Following Questions and Answers are all new published by CompTIA
Official Exam Center

-  **Instant Download** After Purchase
-  **100% Money Back** Guarantee
-  **365 Days** Free Update
-  **800,000+** Satisfied Customers





QUESTION 1

A client is receiving certificate errors in other languages when trying to access the company\\'s main intranet site. Which of the following is MOST likely the cause?

- A. DoS
- B. Reflective DNS
- C. Man-in-the-middle
- D. ARP poisoning

Correct Answer: C

QUESTION 2

A network technician is attempting to locate a switch connected to the fourth floor west side of the building. Which of the following will allow quick identification of the switch, when looking at a logical diagram?

- A. Building layout
- B. Patch panel labeling
- C. Packet sniffing
- D. Naming conventions

Correct Answer: D

The building in this question has several floors and the floors are large enough to be identified by area such as 'west side\\' etc. It is likely that a logical diagram of the network in such a building would be quite complicated and the network is likely to have several switches. A naming convention is a standard for naming items, in this case, networking components. When it comes to naming switches, using names like Switch1, Switch2 etc. for example won\\'t help when you need to know where the switches are located. In a building with multiple floors with each floor large enough to be defined by area names, you could a naming convention like SW1-FL4-WS where SW1 identifies the item as a Switch with the number 1, FL4 identifies the location as Floor 4 and WS further identifies the location as West Side. Using this convention, switch number 2 on the third floor east side would be named SW2-FL3-ES.

QUESTION 3

A network technician is doing a wireless audit and finds an SSID that does not match the company\\'s SSID. The company uses the SSID of ABC123, and the SSID the technician found is Default. Which of the following threats did the network technician find?

- A. AP isolation
- B. DDoS
- C. Evil twin



D. Rogue AP

Correct Answer: D

QUESTION 4

There has been an increased amount of successful social engineering attacks at a corporate office. Which of the following will reduce this attack in the near future?

- A. Helpdesk training
- B. Appropriate use policy
- C. User awareness training
- D. Personal Identifiable Information

Correct Answer: C

QUESTION 5

A user reports they are unable to access a file on a mapped network drive. A technician discovers the server where the file is located did not come back online after last night's power outage and manually powers the server back online. The technician then verifies the user can connect to their file. Which of the following troubleshooting steps should the technician do NEXT?

- A. Escalate by following change procedures
- B. Establish a plan of action to resolve the problem
- C. Document findings, actions, and outcomes
- D. Question the user

Correct Answer: C

QUESTION 6

DRAG DROP

Your company recently purchased a new building down the street from the existing office.

For each of the tasks below, select the appropriate antenna type and encryption object for all wireless access point (AP).

1.

Create an encrypted wireless connection between the two buildings that BEST controls signal propagation, while maximizing security.
- 2.



Restrict the wireless signal generated by the access points (AP's) inside Building 1, so that it minimizes broadcast beyond the building.

3.

Maximize wireless coverage inside Building 1.

4.

Building 1's internal wireless network is for visitors only and must not require any special configuration on the visitor's device to connect.

Select and Place:

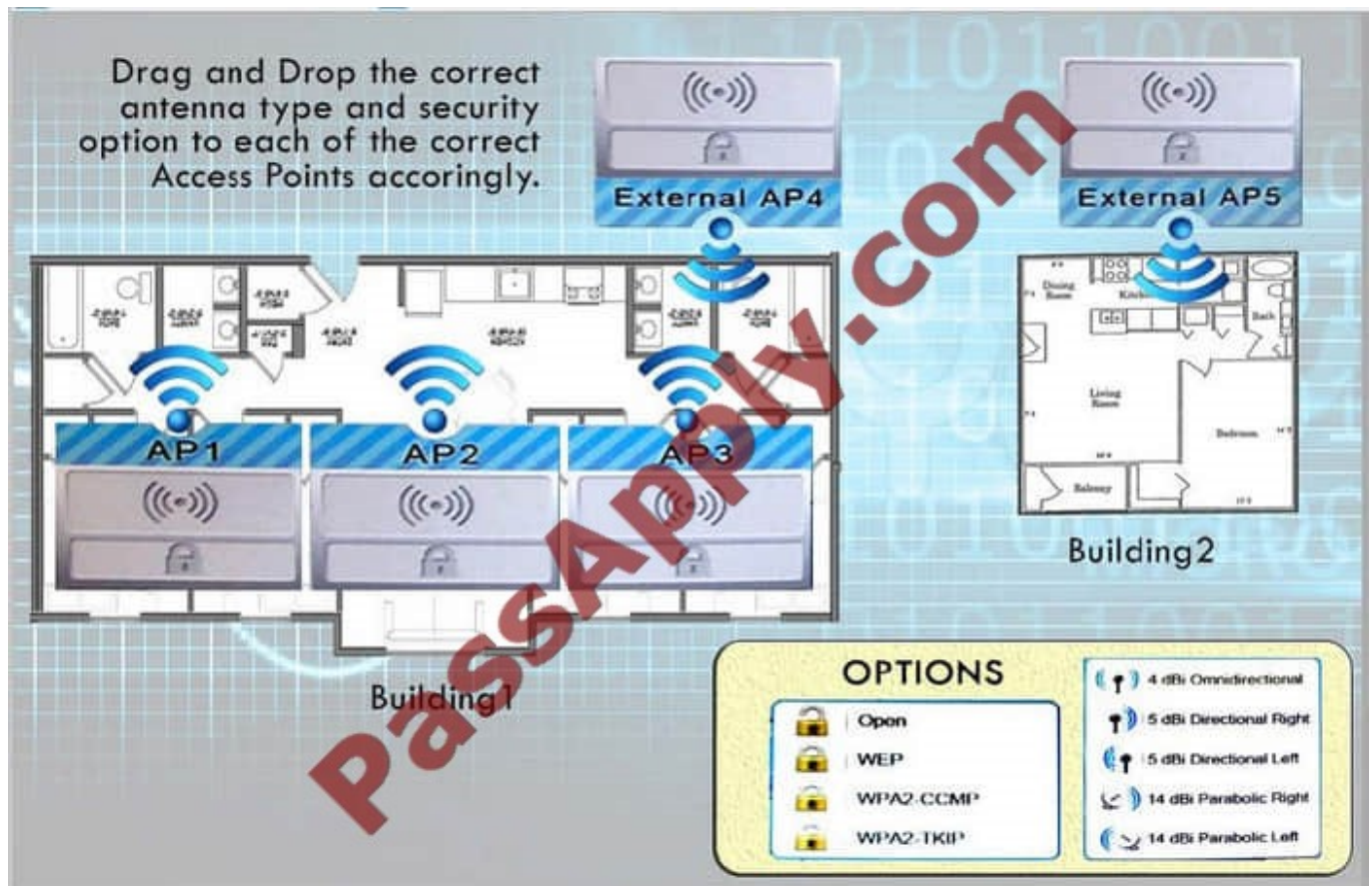

Correct Answer:

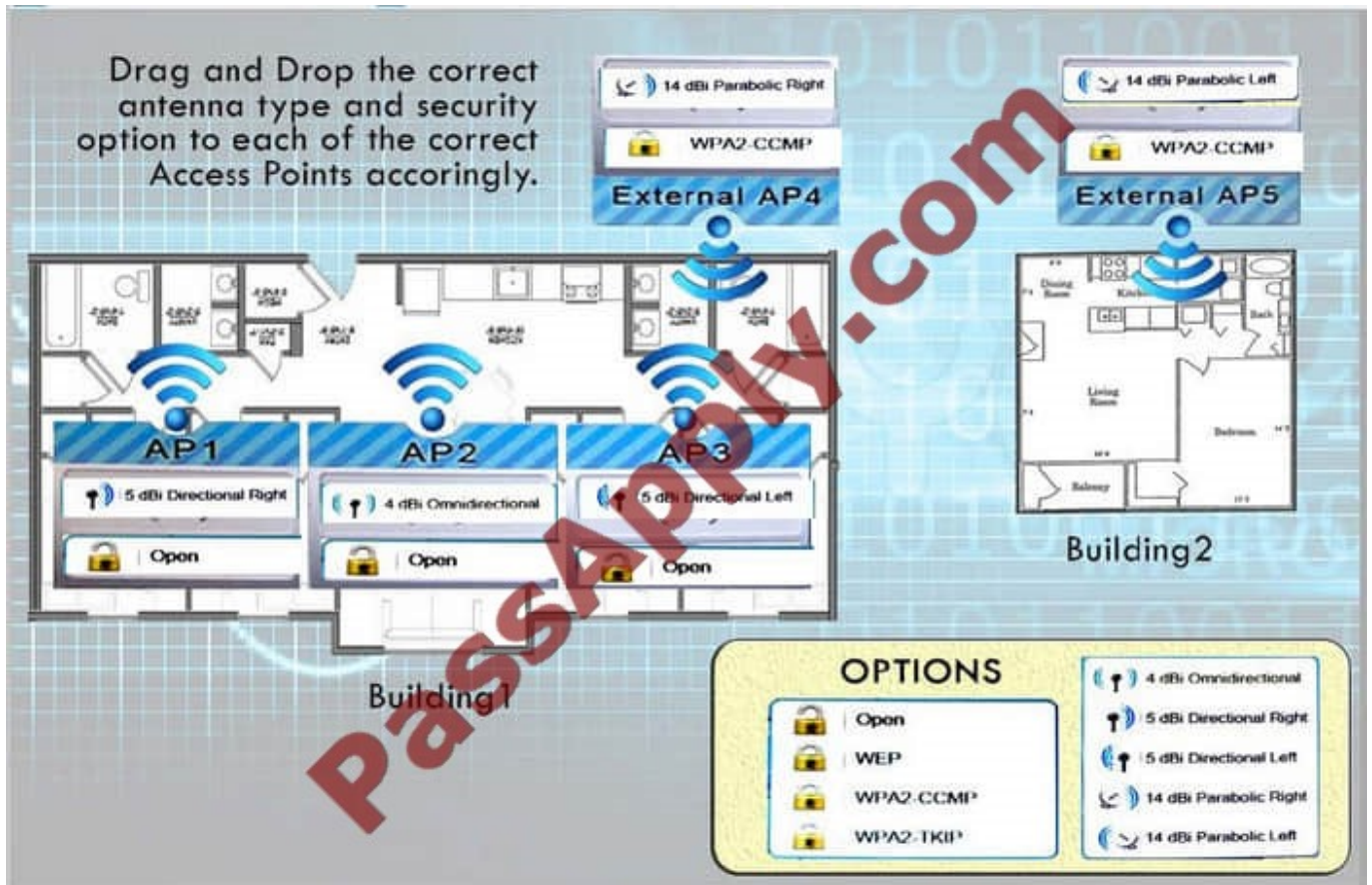

QUESTION 7

A new threat is hiding traffic by sending TLS-encrypted traffic outbound over random ports. Which of the following technologies would be able to detect and block this traffic?

- A. Intrusion detection system
- B. Application aware firewall
- C. Stateful packet inspection
- D. Stateless packet inspection

Correct Answer: C

QUESTION 8

A network technician is working on a large project involving the cabling of a new commercial building. The project involves working with a variety of toxic liquids, some of which require special handling. The technician wants to gain more insight into how items should be handled and stored, and what safety considerations must be made for each item being utilized on the project. Which of the following should the technician review to gather the information needed?



- A. ESD warnings
- B. NIST publications
- C. FIPS
- D. ISO Standards
- E. IEEE Code
- F. MSDS

Correct Answer: F

https://en.wikipedia.org/wiki/Safety_data_sheet

QUESTION 9

Which of the following methods would be implemented to correct a network slowdown caused by excessive video streaming?

- A. Traffic shaping
- B. Proxy server
- C. VPN concentrator
- D. High availability

Correct Answer: A

Explanation: As traffic shaping will prioritize the video packets over another packets and then video packets will travel fast on bandwidth.

QUESTION 10

Which of the following is the minimum subnet mask to allow 172.16.1.5 and 172.16.4.3 to be on the same subnet?

- A. /19
- B. /21
- C. /22
- D. /24

Correct Answer: B

QUESTION 11

Ann, a network administrator, is in the process of cleaning network switches for resale. Ann splashes the cleaning agent



in her eye and needs to know the procedure of cleansing her eye. To which of the following should Ann refer?

- A. EULA
- B. MSDS
- C. SLA
- D. MOU

Correct Answer: B

QUESTION 12

A network engineer is designing a campus-wide wireless network. Wireless access points will be distributed across the campus for maximum availability. The network is to be designed to handle a large number of roaming wireless devices. Which of the following features should the engineer use in order to dynamically limit the number of devices in each broadcast domain?

- A. VLAN pooling
- B. Subnetting
- C. WPA2
- D. LWAPP

Correct Answer: D

https://en.wikipedia.org/wiki/Lightweight_Access_Point_Protocol

[N10-006 PDF Dumps](#)

[N10-006 Exam Questions](#)

[N10-006 Braindumps](#)



VCE & PDF

PassApply.com

<https://www.passapply.com/N10-006.html>

2021 Latest passapply N10-006 PDF and VCE dumps Download

To Read the [Whole Q&As](#), please purchase the [Complete Version](#) from [Our website](#).

Try our product !

100% Guaranteed Success

100% Money Back Guarantee

365 Days Free Update

Instant Download After Purchase

24x7 Customer Support

Average 99.9% Success Rate

More than 800,000 Satisfied Customers Worldwide

Multi-Platform capabilities - [Windows](#), [Mac](#), [Android](#), [iPhone](#), [iPod](#), [iPad](#), [Kindle](#)

We provide exam PDF and VCE of Cisco, Microsoft, IBM, CompTIA, Oracle and other IT Certifications.
You can view Vendor list of All Certification Exams offered:

<https://www.passapply.com/allproducts>

Need Help

Please provide as much detail as possible so we can best assist you.

To update a previously submitted ticket:

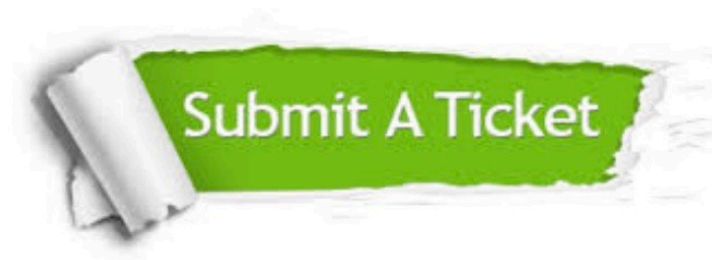

 One Year Free Update Free update is available within One Year after your purchase. After One Year, you will get 50% discounts for updating. And we are proud to boast a 24/7 efficient Customer Support system via Email.	 Money Back Guarantee To ensure that you are spending on quality products, we provide 100% money back guarantee for 30 days from the date of purchase.	 Security & Privacy We respect customer privacy. We use McAfee's security service to provide you with utmost security for your personal information & peace of mind.
---	---	--

Any charges made through this site will appear as Global Simulators Limited.

All trademarks are the property of their respective owners.

Copyright © passapply, All Rights Reserved.