



# 70-348<sup>Q&As</sup>

Managing Projects and Portfolios with Microsoft PPM

## Pass Microsoft 70-348 Exam with 100% Guarantee

Free Download Real Questions & Answers **PDF** and **VCE** file from:

<https://www.passapply.com/70-348.html>

100% Passing Guarantee  
100% Money Back Assurance

Following Questions and Answers are all new published by Microsoft  
Official Exam Center

-  **Instant Download** After Purchase
-  **100% Money Back** Guarantee
-  **365 Days** Free Update
-  **800,000+** Satisfied Customers





### QUESTION 1

You are the Microsoft PPM administrator for a large organization.

You need to ensure that line managers can delegate timesheet approvals to their team members.

Which three actions should you perform in sequence? To answer, move the appropriate actions from the list of actions to the answer area, and arrange them in the correct order

Select and Place:

The screenshot shows a drag-and-drop interface. On the left, under the heading "Actions", there is a list of five items:

- Switch to **SharePoint Permission Mode**.
- Set the value of the **Manage Resource Delegates** category permission to **Allow**.
- Switch to **Project Permission Mode**.
- Add the line managers to a new group. Set the value of the **Manage My Delegates** permission for the group to **Allow**.
- Instruct the line managers to set up the delegation by using the **Manage Delegates** option from the

On the right, under the heading "Answer Area", there are two empty boxes and a vertical scrollbar. A watermark "www.PassApply.com" is visible across the interface.

Correct Answer:

The screenshot shows the same interface as above, but with three actions moved to the "Answer Area" in the correct sequence:

- Switch to **Project Permission Mode**.
- Add the line managers to a new group. Set the value of the **Manage My Delegates** permission for the group to **Allow**.
- Set the value of the **Manage Resource Delegates** category permission to **Allow**.

The "Actions" list on the left now only contains the first and last items from the previous screenshot. A watermark "www.PassApply.com" is visible across the interface.

### QUESTION 2

You are a project manager in an organization that uses Microsoft PPM.



You have been given additional responsibilities managing existing projects created by another project manager.

When reviewing the project plan, you observe that some of the upcoming tasks are assigned to a generic resource.

You need to update the generic tasks to use defined resources

Which type of resource should you use?

- A. Material
- B. Cost
- C. Budget
- D. Work

Correct Answer: C

### QUESTION 3

You are a project manager and want to display key deliverables associated with your project The tasks that produce deliverables are already on the project schedule.

You need to ensure that the deliverables are visible on the project site.

For each of the following statements, select Yes if the statement is true. Otherwise, select No.

Hot Area:

Statement	Yes	No
In Microsoft Project, use Create Deliverables to make the deliverables visible.	<input type="radio"/>	<input type="radio"/>
In Microsoft Project, use Sync Dependencies to make the deliverables visible.	<input type="radio"/>	<input type="radio"/>
To add the deliverables, edit the Deliverable list in the Project Site.	<input type="radio"/>	<input type="radio"/>

Correct Answer:



Statement	Yes	No
In Microsoft Project, use Create Deliverables to make the deliverables visible.	<input checked="" type="checkbox"/>	<input type="checkbox"/>
In Microsoft Project, use Sync Dependencies to make the deliverables visible.	<input checked="" type="checkbox"/>	<input type="checkbox"/>
To add the deliverables, edit the Deliverable list in the Project Site.	<input type="checkbox"/>	<input checked="" type="checkbox"/>

#### QUESTION 4

Your company has had several large projects fail due to cost overruns and the lack of available resources. These projects use an enterprise project type named Large IT Project and use a workflow to govern the approval of the projects. The

workflow consists of four phases; Initiate, Plan, Execute, and Close.

You need to use Microsoft PPM to compare the value that a new project provides with the cost of implementing the project.

Which three configuration changes should you make? Each correct answer presents part of the solution.

- A. Navigate to PWA Settings Edit the Large IT Project project type, and in the Available Project Detail Page section, add the Strategic Impact form.
- B. Create a project-level custom field that will be used to enter the total cost of a project
- C. Define your company's strategic drivers, and enter them into the Strategic Impact form.
- D. Create a project-level custom field that will be used to enter the value statements of why this project should be undertaken.
- E. Define your company's strategic drivers and enter them into the driver library.
- F. In PWA Settings, edit and then save the stage information. In the Available Project Detail Page section, add the Strategic Impact.

Correct Answer: BCE

#### QUESTION 5

You are a team member on a project that uses Microsoft PPM timesheets for work management. You submit your timesheet by selecting Turn In Final Timesheet. You observe that some actual work is missing from your timesheet.

You need to be able to enter actual work in your timesheet for the project period.

Which three actions should you perform in sequence? To answer, move the appropriate actions from the list of actions



to the answer area, and arrange them in the correct order

Select and Place:



Correct Answer:

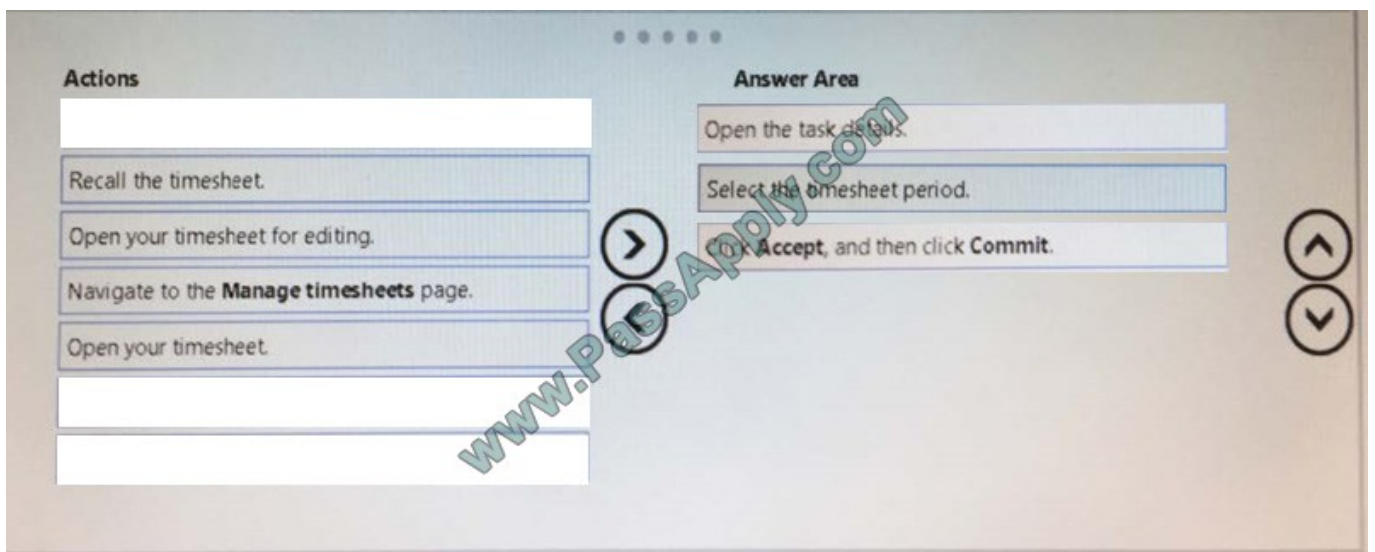

[70-348 PDF Dumps](#)

[70-348 VCE Dumps](#)

[70-348 Practice Test](#)





To Read the [Whole Q&As](#), please purchase the [Complete Version](#) from [Our website](#).

## Try our product !

100% Guaranteed Success  
100% Money Back Guarantee  
365 Days Free Update  
Instant Download After Purchase  
24x7 Customer Support  
Average 99.9% Success Rate  
More than 800,000 Satisfied Customers Worldwide  
Multi-Platform capabilities - [Windows](#), [Mac](#), [Android](#), [iPhone](#), [iPod](#), [iPad](#), [Kindle](#)

We provide exam PDF and VCE of Cisco, Microsoft, IBM, CompTIA, Oracle and other IT Certifications. You can view Vendor list of All Certification Exams offered:

<https://www.passapply.com/allproducts>

## Need Help

Please provide as much detail as possible so we can best assist you.  
To update a previously submitted ticket:



 <p><b>One Year Free Update</b> Free update is available within One Year after your purchase. After One Year, you will get 50% discounts for updating. And we are proud to boast a 24/7 efficient Customer Support system via Email.</p>	 <p><b>Money Back Guarantee</b> To ensure that you are spending on quality products, we provide 100% money back guarantee for 30 days from the date of purchase.</p>	 <p><b>Security &amp; Privacy</b> We respect customer privacy. We use McAfee's security service to provide you with utmost security for your personal information &amp; peace of mind.</p>
---	---	--

Any charges made through this site will appear as Global Simulators Limited.  
All trademarks are the property of their respective owners.  
Copyright © passapply, All Rights Reserved.