



70-333^{Q&As}

Deploying Enterprise Voice with Skype for Business 2015

Pass Microsoft 70-333 Exam with 100% Guarantee

Free Download Real Questions & Answers **PDF** and **VCE** file from:

<https://www.passapply.com/70-333.html>

100% Passing Guarantee
100% Money Back Assurance

Following Questions and Answers are all new published by Microsoft
Official Exam Center

-  **Instant Download** After Purchase
-  **100% Money Back** Guarantee
-  **365 Days** Free Update
-  **800,000+** Satisfied Customers





QUESTION 1

You need to ensure that the new finance department users can sign in to the Aries phone without tethering the phone to their computer.

Which two actions should you perform?

NOTE: Each correct answer presents part of the solution.

- A. Assign a PIN for the users by running the Set-CsClientPin Skype for Business Management Shell command. Inform users about the new PIN.
- B. Tell users to log on to the device with their Active Directory Domain Services (AD DS) credentials and then set a Device Lock PIN.
- C. Tell users to sign in to the phones with their Active Directory Domain Services (AD DS) credentials.
- D. Tell users to change their PIN by using the dial-in conferencing webpage.

Correct Answer: AD

QUESTION 2

WingTip Toys is in the process of completing a rollout of Skype for Business Server 2015 Enterprise Voice. They want to provide voice mail capabilities to all users.

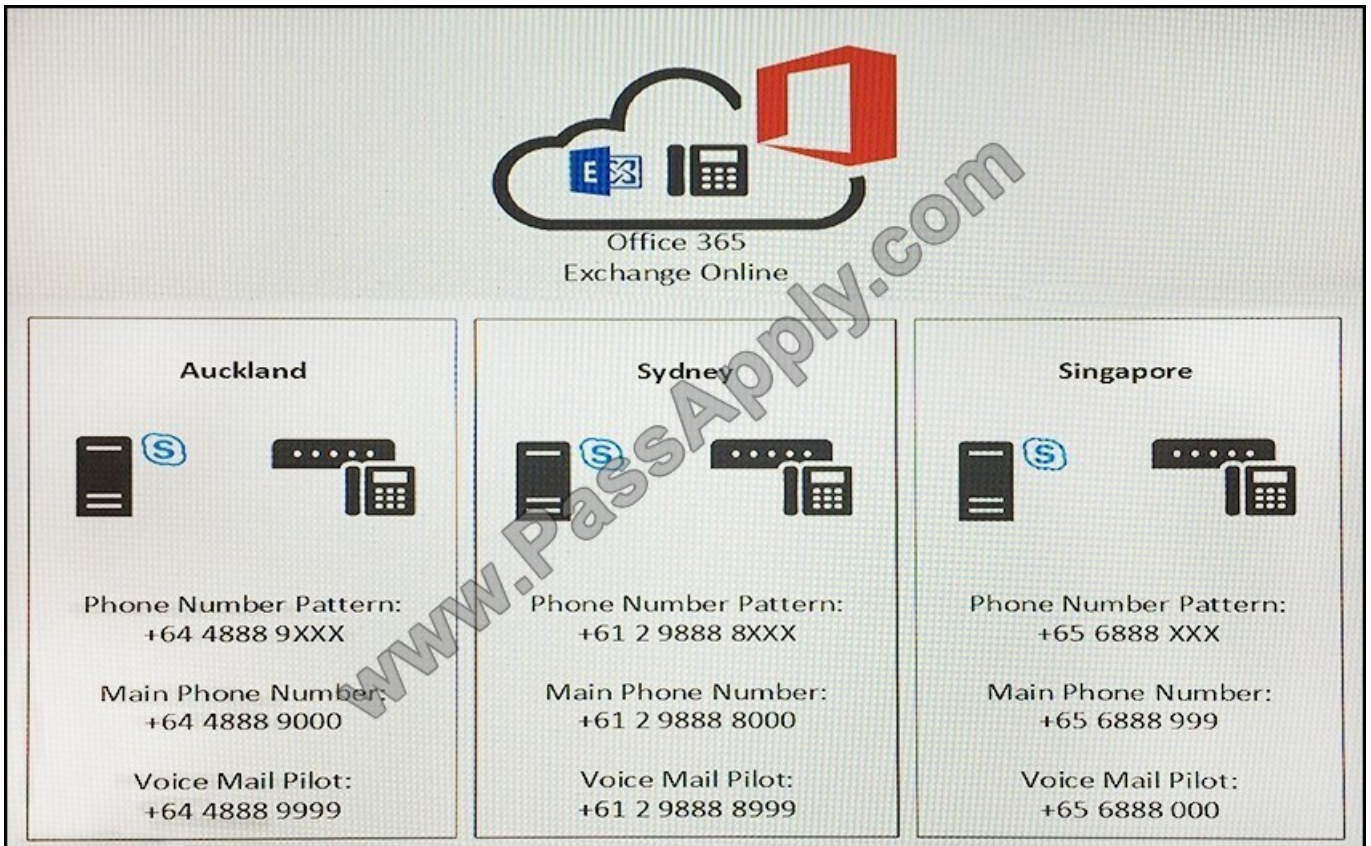

The information below was provided to facilitate the design of Exchange Online Unified Messaging (UM) implementation.

Use the drop-down menus to select the answer choice that answers each question. Each correct answer is worth one point.

Hot Area:

Answer Area

To design Outlook Voice Access for Sydney, what is the most appropriate design option that will accomplish the goal with minimum change to Exchange Online configuration?

- Create a Sydney Exchange Unified Messaging Dial Plan, assign +61298889000 as subscriber access number
- Create a Sydney Exchange Unified Messaging Dial Plan, assign +61298889999 as subscriber access number
- Modify the existing Exchange Unified Messaging Dial Plan, assign +61298889000 as subscriber access number
- Modify the existing Exchange Unified Messaging Dial Plan, assign +61298889999 as subscriber access number

Choose the appropriate design option for Singapore while minimizing the change to Exchange Online configuration?

- Create a Singapore Exchange Unified Messaging Dial Plan, assign +656888000 as subscriber access number
- Create a Singapore Exchange Unified Messaging Dial Plan, assign +656888999 as subscriber access number
- Modify the existing Exchange Unified Messaging Dial Plan, assign +656888000 as subscriber access number
- Modify the existing Exchange Unified Messaging Dial Plan, assign +656888999 as subscriber access number

Correct Answer:



Answer Area

To design Outlook Voice Access for Sydney, what is the most appropriate design option that will accomplish the goal with minimum change to Exchange Online configuration?

▼
Create a Sydney Exchange Unified Messaging Dial Plan, assign +61298889000 as subscriber access number
Create a Sydney Exchange Unified Messaging Dial Plan, assign +61298889999 as subscriber access number
Modify the existing Exchange Unified Messaging Dial Plan, assign +61298889000 as subscriber access number
Modify the existing Exchange Unified Messaging Dial Plan, assign +61298889999 as subscriber access number

Choose the appropriate design option for Singapore while minimizing the change to Exchange Online configuration?

▼
Create a Singapore Exchange Unified Messaging Dial Plan, assign +656888000 as subscriber access number
Create a Singapore Exchange Unified Messaging Dial Plan, assign +656888999 as subscriber access number
Modify the existing Exchange Unified Messaging Dial Plan, assign +656888000 as subscriber access number
Modify the existing Exchange Unified Messaging Dial Plan, assign +656888999 as subscriber access number

QUESTION 3

You need to define the goals that you would like to achieve after you perform usage modeling of Skype for Business traffic. Which two goals should you establish? Each correct answer presents part of the solution.

- A. Confirm that bandwidth is sufficient for 40 new Litware, Inc. Skype for Business users.
- B. Confirm that the volume of Skype for Business traffic does not exceed 5 megabits per second (Mbps).
- C. Confirm that bandwidth is sufficient for 80 new Litware, Inc. Skype for Business users.
- D. Confirm that the volume of Skype for Business traffic does not exceed 25 percent of wide area network (WAN) bandwidth.
- E. Confirm that bandwidth is sufficient for Microsoft Office 365 Hybrid Skype for Business deployment.

Correct Answer: CD

QUESTION 4

A company has offices in New York and Seattle. The offices contain a total of five subnets. The subnets are configured as shown in the following table.

Office	Floor	Subnet	Subnet mask
New York	First	172.16.1.0	255.255.255.0
New York	Second	172.16.2.0	255.255.255.0
New York	Third	172.16.3.0	255.255.255.0
Seattle	First	172.16.4.0	255.255.255.0
Seattle	Second	172.16.5.0	255.255.255.0



You have a Skype for Business Server 2015 infrastructure. You deploy the Skype for Business client to all client computers. You plan to deploy Call Admission Control (CAC). You must minimize the number of regions, sites, and subnets for

the deployment.

You need to design the network topology for the planned deployment. The solution must ensure that different bandwidth policies can be applied to each floor of each office.

How many regions, site and subnets should you deploy? To answer, select the appropriate number of regions, sites, and subnets in the answer area.

Hot Area:

Answer Area

Regions:

	▼
1	
2	
3	
4	
5	

Sites:

	▼
1	
2	
3	
4	
5	

Subnets:

	▼
1	
2	
3	
4	
5	

Correct Answer:



Answer Area

Regions:

	▼
1	
2	
3	
4	
5	

Sites:

	▼
1	
2	
3	
4	
5	

Subnets:

	▼
1	
2	
3	
4	
5	

QUESTION 5

You need to plan a solution to allow masking of a calling number.

How can a calling number of a Skype for Business user be changed to match the main number of the company?

- A. Create a new normalization rule and add it to the global dial plan.
- B. Use the Skype for Business control panel to mask the calling number.
- C. Create a trunk translation rule that masks the called number.
- D. Use the voice gateway to mask the called number.

Correct Answer: B



To Read the [Whole Q&As](#), please purchase the [Complete Version](#) from [Our website](#).

Try our product !

100% Guaranteed Success
100% Money Back Guarantee
365 Days Free Update
Instant Download After Purchase
24x7 Customer Support
Average 99.9% Success Rate
More than 800,000 Satisfied Customers Worldwide
Multi-Platform capabilities - [Windows](#), [Mac](#), [Android](#), [iPhone](#), [iPod](#), [iPad](#), [Kindle](#)

We provide exam PDF and VCE of Cisco, Microsoft, IBM, CompTIA, Oracle and other IT Certifications. You can view Vendor list of All Certification Exams offered:

<https://www.passapply.com/allproducts>

Need Help

Please provide as much detail as possible so we can best assist you.
To update a previously submitted ticket:

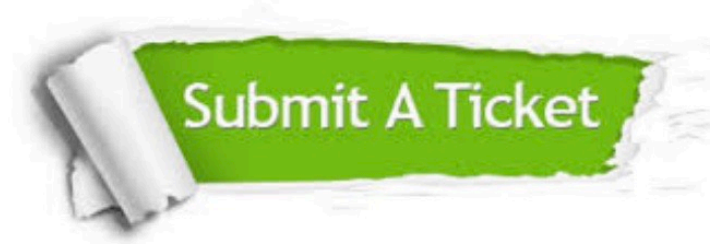

 <p>One Year Free Update Free update is available within One Year after your purchase. After One Year, you will get 50% discounts for updating. And we are proud to boast a 24/7 efficient Customer Support system via Email.</p>	 <p>Money Back Guarantee To ensure that you are spending on quality products, we provide 100% money back guarantee for 30 days from the date of purchase.</p>	 <p>Security & Privacy We respect customer privacy. We use McAfee's security service to provide you with utmost security for your personal information & peace of mind.</p>
---	---	--

Any charges made through this site will appear as Global Simulators Limited.
All trademarks are the property of their respective owners.
Copyright © passapply, All Rights Reserved.